

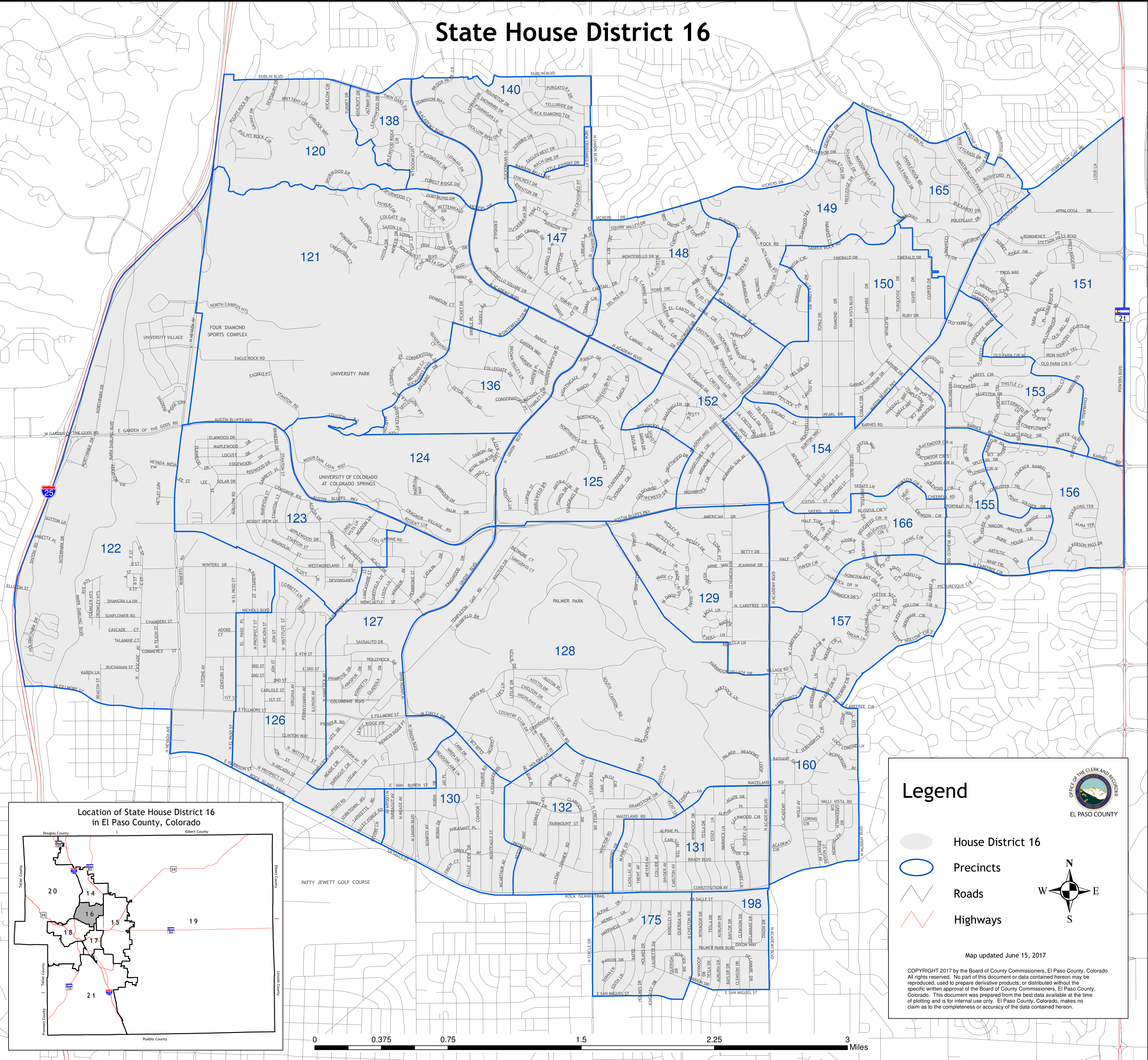

# State House District 16

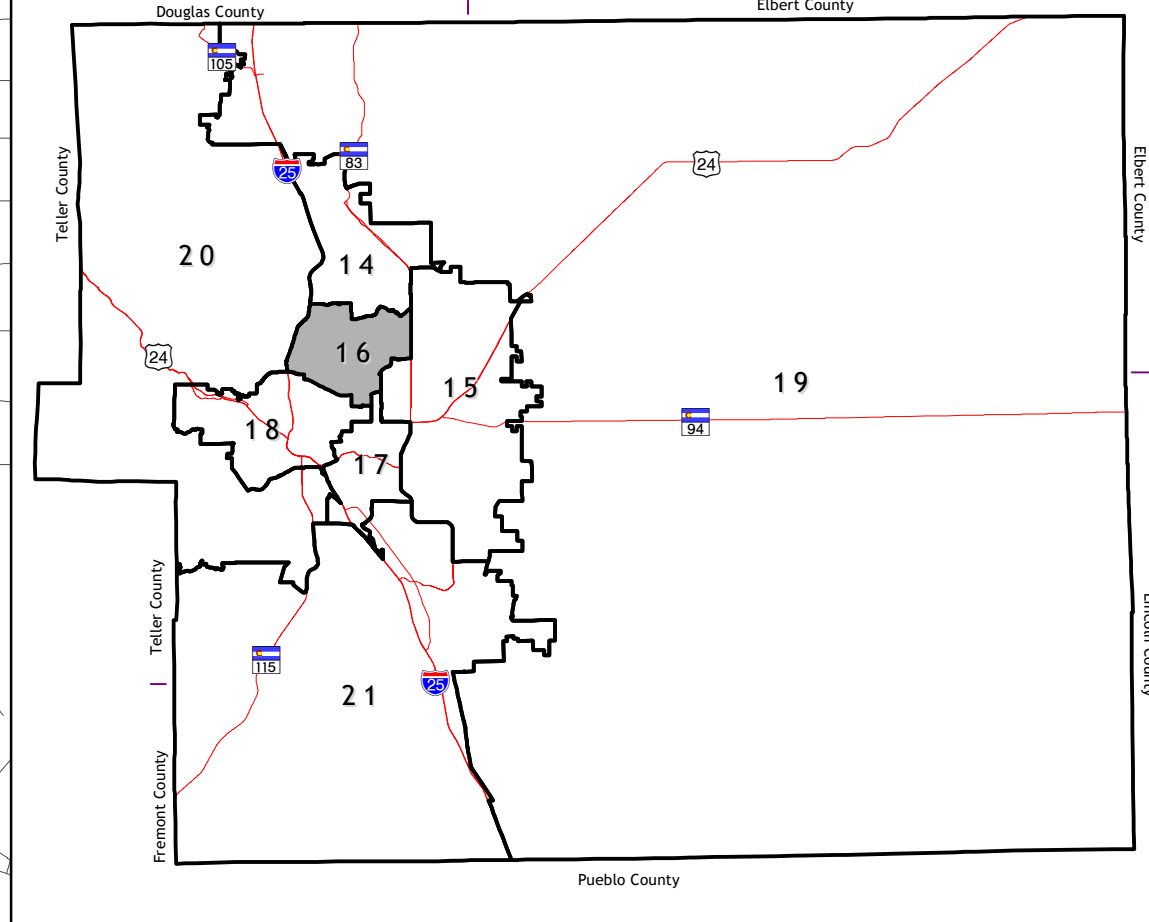

Location of State House District 16 in El Paso County, Colorado





OFFICE OF THE CLERK AND RECORDER  
EL PASO COUNTY

## Legend

- House District 16
- Precincts
- Roads
- Highways

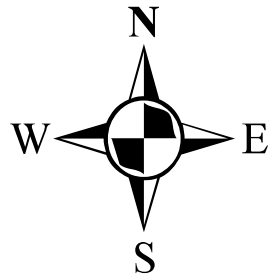

N  
W E  
S

Map updated June 15, 2017

COPYRIGHT 2017 by the Board of County Commissioners, El Paso County, Colorado. All rights reserved. No part of this document or data contained hereon may be reproduced, used to prepare derivative products or distributed without the specific written approval of the Board of County Commissioners, El Paso County, Colorado. This document was prepared from the best data available at the time of plotting and is for internal use only. El Paso County, Colorado, makes no claim as to the completeness or accuracy of the data contained hereon.

